



Class I, Div. 1 & 2, Groups B,C,D
Class I, Zones 1 & 2, Groups IIB, IIA
Class II, Div. 1 & 2, Groups E,F,G
Class III
NEMA 3, 4, 4X, 7(B,C,D) 9(E,F,G)

See Area Classification Chart below

FEATURES-SPECIFICATIONS

Applications

G Series custom control panel operators are designed for use in hazardous locations when installed in suitable enclosures such as B7E EXB, XJB, DB, SWB and GCS Series boxes and B7, Y7 Starter Enclosures.

Features

- Operators are all aluminum except for certain movable parts which are stainless steel, all other parts such as screws are either stainless steel or plated steel
- Threaded bodies are all 3/4"-14 NPSM thread
- Control stations can be grouped into a single assembly thus reducing installation time and cost
- Junction boxes may be used to mount operators along with glass lens for viewing internally mounted meters. Additional relays, timers, terminal blocks, or other equipment may also be internally mounted to provide a single centralized control unit.
- Custom operators other than standard assemblies listed may be ordered by proper catalog number from custom operator ordering system pages C40 & C41

Electrical Rating

Push button stations, selector switches Heavy duty 600 VAC max.
Pilot lights 120 VAC.

Dimensions

See Dimensional information for G Series operators on page C42.

Recommended Operator Selection

Short Style

DB/SWB/GCS Enclosures. Assemblies with wall thickness up to 1/2" thick.

Long Style

All B7E/XJB Enclosures. EXB (see page E12) enclosures with cover thickness up to 1-1/2" thick.

Extended Style

EXB larger size enclosures (see page E12) with cover thickness up to 2-1/2" thick.

Killark long and extended push buttons, selector switches, reset and

potentiometer operators are CENELEC/ATEX EExd IIB+H2 when installed in series EXB*CEN and GR*CEN enclosures.

For pilot lights and illuminated push buttons in CENELEC/ATEX applications see page C33.

CONTACT BLOCK RATINGS						
CURRENT	120 VAC	240 VAC	480 VAC	600 VAC	125 VDC	250 VDC
Inrush	60	30	15	12	.55	.275
Breaking	6	3	1.5	1.2	.55	.275
Carrying	10	10	10	10	2.50	2.50

Note: Contact blocks can be stacked four deep maximum.

AREA CLASSIFICATION CHART FOR OPERATORS					
G01 ^④	G017 ^②	G030 ^②	G057 ^②	G0L2 ^④	G0L38 ^③
G02 ^④	G018 ^②	G034 ^②	G058 ^②	G0L3 ^④	G0L39 ^③
G05 ^④	G019 ^②	G035 ^② G036 ^③	G059 ^②	G0L4 ^④	G0L113 ^③
G06 ^④	G021 ^②	G037 ^③	G0113 ^③	G0L5 ^④	G0L114 ^③
G07 ^④	G022 ^②	G038 ^③	G0114 ^③	G0L6 ^④	G0LRST ^④
G08 ^③	G023 ^②	G039 ^③	G0133 ^②	G0L7 ^④ G0L8 ^③	G0M1 ^⑤
G010 ^④	G025 ^②	G040 ^①	G0134 ^②	G0L14 ^④	G0R11 ^④
G014 ^④	G026 ^②	G050 ^②	G0B3 ^④	G0L15 ^④	G0RST ^④
G015 ^④	G027 ^②	G051 ^②	G0B4 ^④	G0L36 ^③	G011388 ^②
G016 ^②	G028 ^②	G056 ^②	G0L1 ^④	G0L37 ^④	G011372 ^②

① Class II Div. 1 & 2 Group EFG NEMA 9EFG
 ② Class I Div. 1 & 2 Group CD, Class II Div. 1 & 2 Group EFG, Class III NEMA 7CD, 9EFG
 ③ Class I Div. 1 & 2 Group BCD, Class II Div. 1 & 2 Group EFG, Class III NEMA 3, 4, 7BCD, 9EFG
 ④ Class I Div. 1 & 2 Group BCD, Class II Div. 1 & 2 Group EFG, Class III NEMA 3, 4, 4X, 7BCD, 9EFG
 ⑤ Class I Div. 1 & 2 Group CD, Class II Div. 1 & 2 Group EFG, Class III NEMA 3, 4, 7CD, 9EFG



Push Button Green



Push Button Red



Mushroom Push Button



Double Push Button

Class I, Div. 1 & 2, Groups B,C,D[Ⓞ]
Class I, Zones 1 & 2, Groups IIB, IIA
Class II, Div. 1 & 2, Groups E,F,G
Class III
NEMA 3, 4, 4X, 7(B,C,D) 9(E,F,G)

See Area Classification Chart
page C40 for Details

Listed - File E12379

Certified - File LR11714
See files for details or call Killark.

FEATURES-SPECIFICATIONS

G SINGLE PUSH BUTTON (MOMENTARY CONTACT)						
CATALOG NUMBER [Ⓞ]			COLOR	CONTACT TYPE [Ⓞ]	NAMEPLATE MARKING [Ⓞ]	
SHORT [Ⓞ]	LONG	EXTENDED				
G021-GZ1B	G01-GX1B N34	GOL1G1	Green		Start or Stop	
G021-KZ1C	G01-KX1C N34	GOL1K1	Black		Reset or Blank	
G021-RZ2B	G01-RX2B N34	GOL1R2	Red		Start or Stop	
G021-KZ2C	G01-KX2C N34	GOL1K2	Black		Reset or Blank	
G021-GZ3C	G01-GX3C N34	GOL1G3	Green		Reset or Blank	
G021-RZ3C	G01-RX3C N34	GOL1R3	Red		Reset or Blank	
G021-KZ3C	G01-KX3C N34	GOL1K3	Black		Reset or Blank	
G021-GZ0C	G01-GX0C N34	GOL1G	Green	None	Reset or Blank	
G021-RZ0C	G01-RX0C N34	GOL1R	Red		Reset or Blank	
G021-KZ0C	G01-KX0C N34	GOL1K	Black		Reset or Blank	

G SINGLE PUSH BUTTON (MAINTAINED CONTACT) MUSHROOM HEAD PUSH - PULL OPERATION						
GOM21-GM3C	GOM1-GM3C N34	GOML1G3	Green		Blank	
GOM21-RM3C	GOM1-RM3C N34	GOML1R3	Red		Blank	
GOM21-KM3C	GOM1-KM3C N34	GOML1K3	Black		Blank	
GOM21-GM0C	GOM1-GM0C N34	GOML1G	Green	None	Blank	
GOM21-RM0C	GOM1-RM0C N34	GOML1R	Red		Blank	
GOM21-KM0C	GOM1-KM0C N34	GOML1K	Black		Blank	

G DOUBLE PUSH BUTTON (MOMENTARY CONTACT)						
G022-GR12D	G02-GR12D N34	GOL2GR12	Green/Red			Start/Stop or Blank
G022-KK12D	G02-KK12D N34	GOL2KK12	Black/Black			Start/Stop or Blank
G022-GR33D	G02-GR33D N34	GOL2GR33	Green/Red			Start/Stop or Blank
G022-KK33D	G02-KK33D N34	GOL2KK33	Black/Black			Start/Stop or Blank
G022-GR00D	G02-GR00D N34	GOL2GR	Green/Red	None		Start/Stop or Blank
G022-KK00D	G02-KK00D N34	GOL2KK	Black/Black			Start/Stop or Blank

G DOUBLE PUSH BUTTON (MAINTAINED CONTACT) [Ⓞ]						
—	GOR11-GR6D N34	—	Green/Red			Start/Stop or Blank
—	GOR11-GR7D N34	—	Green/Red			Start/Stop or Blank
—	GOR11-GR8D N34	—	Green/Red			Start/Stop or Blank
—	GOR11-GR0D N34	—	Green/Red			Start/Stop or Blank

[Ⓞ] Refer to catalog page C30 to select proper operator for enclosure, pages C38 & C39 for accessories, page C30 for complete details on Area Classification of operators, page C42 for Dimensional information.

[Ⓜ] Nameplates are double sided.

[Ⓝ] Contact Blocks are shown in their normal position.

[Ⓞ] Short style operators are suitable for Class I Group C & D, Class II Group E,F,G only.

[Ⓟ] When pressed, the green button will remain in a depressed position. Pressing red button releases green from the depressed position.



KILLARK®



Example: **G01** — **RX** **2** **B** **N34**
 FORM **COLOR** **CONTACTS** **NAMEPLATE** **CONSTANT**
 SINGLE PUSH BUTTON **(RED)** **(1 N.C.)** **(STOP)**

NOTE: For faster delivery on custom operators order push buttons and selector switches without contact blocks and order contacts as a separate item.

FEATURES-SPECIFICATIONS

- Select operator form and style (short, long or extended).
- Using the catalog numbering system below, insert the proper letter or number symbol as shown in appropriate charts on page C41, write the complete catalog number.
- Spaces in catalog numbering system which have symbol already filled in cannot be changed.
- Order accessories as separate item from pages C38 & C39.
- Add "N34" suffix to the end of all long style operators with the following prefix; G01, G02, G0B3, G0B4, G05, G06, G07, G08, G010, G011, G014, G015, G036, G037, G038, G039.

CATALOG SERIES	COLOR	VOLTAGE	POSITION	CAM	CONTACTS	NAMEPLATE	KEY LOCK	KEY TYPE	DESCRIPTION
G01 & G021 GOL1	Chart 1				Chart 4	Chart 8			Single push button: (Momentary contact)
G0M1	Chart 1				Chart 4	Chart 8			Single push button: (Maintained contact)
G02 & G022 GOL2	Chart 2				Chart 4	Chart 8			Double push button: (Momentary contact)
G0R11	Chart 2				Chart 4	Chart 8			Double push button: (Maintained contact)
G0B3 & G023 GOL3	Chart 3	Chart 6				Chart 8			Pilot light
G0B4 GOL4	Chart 3	Chart 6			Chart 4	Chart 8			Illuminated push button
G05 & G025 GOL5			Chart 5	Chart 7	Chart 4	Chart 8			Selector switch (Maintained contact)
G06 & G026 GOL6					Chart 4	Chart 8			Selector switch (2 Position, spring return to left)
G07 & G027 GOL7					Chart 4	Chart 8			Selector switch (3 Position, return to center from center)
G014 & G034 GOL14					Chart 4	Chart 8			Selector switch (3 Position, return to center from right)
G015 & G035 GOL15					Chart 4	Chart 8			Selector switch (3 Position, return to center from left)
G08 & G028 GOL8			Chart 5	Chart 7	Chart 4	Chart 8	Chart 9	Chart 10	Key selector switch (Maintained contact)
G036 & G056 GOL36					Chart 4	Chart 8	Chart 9	Chart 10	Key selector switch (2 Position, spring return to left)
G037 & G057 GOL37					Chart 4	Chart 8	Chart 9	Chart 10	Key selector switch (3 Position, spring return to center)
G038 & G058 GOL38					Chart 4	Chart 8	Chart 9	Chart 10	Key selector switch (3 Position, return to center from right)
G039 & G059 GOL39					Chart 4	Chart 8	Chart 9	Chart 10	Key selector switch (3 Position, return to center from left)



CHART 1 - SINGLE BUTTON				
GO1 SYMBOL	GO21 SYMBOL	GOL1 SYMBOL	GOM1 SYMBOL	COLOR
KX	KZ	K	KM	Black
RX	RZ	R	RM	Red
GX	GZ	G	GM	Green

CHART 2 - DOUBLE BUTTON	
SYMBOL	COLOR
KK	Black/Black
GG	Green/Green
RR	Red/Red
RG	Red/Green
KR	Black/Red
KG	Black/Green

CHART 3 - PILOT LIGHT LENS	
SYMBOL	COLOR
A	Amber
B	Blue
C	Clear
F	Frosted
G	Green
R	Red

CHART 4 - CONTACT BLOCKS	
SYMBOL	ARRANGEMENT
1	One N.O. block
2	One N.C. block
3	One universal (One N.O. and one N.C.)
4	One delayed break N.C. block
5	One early make N.O. block
6	Two N.O. blocks
7	Two N.C. blocks
8	Two universal (Two N.O. and two N.C.)
0	Omit contact block

CHART 5 - SELECTOR SWITCHES	
SYMBOL	NO. OF POSITIONS
2	Two
3	Three

CHART 6 - PILOT LIGHT LAMPS		
GO23 SYMBOL	GOB3/GOB4 SYMBOL	VOLTAGE
23	23	120
4	4	24

CHART 7A - SELECTOR SWITCH CAMS							
CAM AND CONTACT SELECTION TABLE FOR 2 AND 3 POSITION SELECTOR OPERATOR							
SYMBOL	CONTACTS BLOCKS	Left position		Center position		Right position	
		LEFT BLOCKS	RIGHT BLOCKS	LEFT BLOCKS	RIGHT BLOCKS	LEFT BLOCKS	RIGHT BLOCKS
A	NC	X	X			0	0
	NO	0	0			X	X
B	NC	X	0	X	X	0	X
	NO	0	X	0	0	X	0
C	NC	X	X	0	0	0	0
	NO	0	0	0	0	X	X
D	NC	0	0	X	X	0	0
	NO	0	0	0	0	X	X
E	NC	0	0	X	X	0	0
	NO	X	X	0	0	0	0
G	NC	X	0	0	X	0	0
	NO	0	0	0	0	X	X

Note: Spring return operators are supplied with special fixed cam. Changes cannot be made for cam substitution.

CHART 7B	
CAM	PART NUMBER
A	0106775B
B	11586ABAB
C	11587ABAB
D	11588ABAB
E	11589ABAB
G	11590ABAB

CHART 8 - NAMEPLATES [Ⓛ]			
SYMBOL	NAMEPLATE MARKINGS		G SERIES FORMS THAT NAMEPLATE CAN BE USED ON
	FRONT	BACK	
A	Omit nameplate	Omit nameplate	All
B	Start	Stop	GO1, 21, 23, 20, 40, GOB3
C	Blank	Reset	GO1, 21, 23, 20, 40, GOB3, GOB4
E	Blank	On	GOR4
F	Blank-Blank	Off-On	GO5, 25, 6, 26, 8, 28, 10, 30, 36, 56
G	Blank-Blank-Blank	Hand-Off-Auto	GO5, 25, 7, 27, 8, 28, 10, 30, 14, 34
H	Blank-Blank-Blank-Blank	Start-Stop	GO5, 25, 10, 30

CHART 9 - KEY LOCK	
SYMBOL	TYPE
22	2 Position key remove left
20	2 Position key remove both
32	3 Position key remove center
30	3 Position key remove all

CHART 10 - KEY STYLE	
SYMBOL	TYPE
D	Keys different
A	Keys alike

[Ⓛ] Symbol not required on extended length GOL part number.



G DIMENSIONS					
SERIES	FIGURE	A	B	C	D
GO1	1	15/16" (24)	1-3/4" (44)	3-7/16" (87)	1-1/4" (32)
GO2	3	13/16" (21)	2" (51)	3-3/4" (95)	—
GOB3	4	1-1/8" (29)	2" (51)	2-3/4" (70)	1-9/16" (40)
GOB4	5	2-3/8" (60)	2-1/4" (57)	4" (101)	1-13/16" (46)
GO5	9	1-5/16" (33)	1-3/4" (44)	3-7/16" (87)	1-1/4" (32)
GO6,GO7,GO14,GO15	9	1-5/16" (33)	1-3/4" (44)	3-13/16" (97)	1-1/4" (32)
GO8	10	2-9/16" (65)	1-3/4" (44)	3-1/2" (89)	1-1/4" (32)
GO10	11	1-5/16" (33)	1-3/4" (44)	4" (101)	1-1/4" (32)
GO16,GO18	7	1-1/4" (32)	1" (25)	13/16" (21)	1-1/2" (38)
GO17,GO19	7	13/16" (21)	1" (25)	13/16" (21)	1-1/2" (38)
GO21	1	15/16" (24)	3/4" (19)	2-7/16" (62)	1-1/4" (32)
GO22	3	13/16" (21)	1" (25)	2-3/4" (70)	—
GO23	4	1-1/8" (29)	1" (25)	1-3/4" (44)	1-9/16" (40)
GO25	9	1-5/16" (33)	3/4" (19)	2-7/16" (62)	1-1/4" (32)
GO26,GO27,GO34,GO35	9	1-5/16" (33)	3/4" (19)	2-13/16" (71)	1-1/4" (32)
GO30	11	1-5/16" (33)	3/4" (19)	3" (76)	1-1/4" (32)
GO36,GO37,GO38,GO39	10	2-9/16" (65)	1-3/4" (44)	3-7/8" (98)	1-1/4" (32)
GO40	2	15/16" (24)	11/16" (17)	1" (25)	1-1/4" (32)
GO50	7	1-1/2" (38)	2" (51)	6-5/16" (160)	2-5/16" (59)
GO51	7	2-1/4" (57)	1-5/8" (41)	5-9/16" (141)	1" (25)
GO56,GO57,GO58,GO59	10	2-9/16" (65)	3/4" (19)	2-7/8" (73)	1-1/4" (32)
GO113,GO114	6	1" (25)	2" (51)	3-5/8" (67)	1-13/16" (46)
GO133,GO134	6	1" (25)	1" (25)	2-5/8" (67)	1-13/16" (46)
GO-11388-078	8	1-5/16" (33)	3/4" (19)	N/A	1-1/2" (38)
GO-11372-093	8	1-5/16" (33)	3/4" (19)	N/A	1-1/2" (38)
GOR11	3	13/16" (21)	2" (51)	4-1/8" (105)	—
GO-RST	2	15/16" (24)	2-5/16" (59)	2-3/8" (+6") (60)	1-1/4" (32)
GOM1	1	1-7/8" (48)	1-7/16" (37)	4" (101)	1-5/8" (41)
EXTENDED LENGTH OPERATORS:					
GOL1	1	15/16" (24)	2-3/4" (70)	4-7/16" (113)	1-1/4" (32)
GOL2	3	13/16" (21)	2-3/4" (70)	4-1/2" (114)	—
GOL3	4	1-1/8" (29)	2-3/4" (70)	3-3/8" (86)	1-9/16" (40)
GOL4	5	2-3/8" (60)	2-3/4" (70)	4-5/8" (117)	1-13/16" (46)
GOL5	9	1-5/16" (33)	2-3/4" (70)	4-7/16" (113)	1-1/4" (32)
GOL6,GOL7,GOL14,GOL15	9	1-5/16" (33)	2-3/4" (70)	4-13/16" (122)	1-1/4" (32)
GOL8	10	2-9/16" (65)	2-3/4" (70)	4-1/2" (114)	1-1/4" (32)
GOL36,GOL37,GOL38,GOL	10	2-9/16" (65)	2-3/4" (70)	4-7/8" (124)	1-1/4" (32)
GOL113,GOL114	6	1" (25)	3" (76)	4-5/8" (117)	1-13/16" (46)
GOLRST	2	15/16" (24)	2-3/4" (70)	3" (+6") (76)	1-1/4" (32)

NOTE: All operators are for installation into a 3/4"-14 NPSM opening except GO50 which is for 1-1/4"-11-1/2 NPSM and GO-11388-078 + GO-11372-093 which are for use in a 3/4"-14 NPT opening.

Special Operators

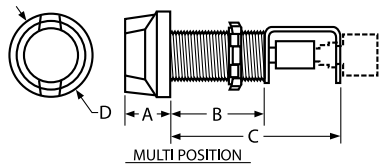

FIGURE 6

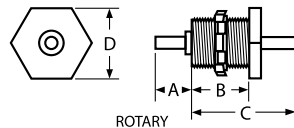

FIGURE 7

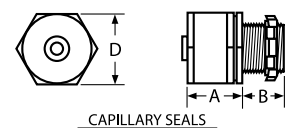

FIGURE 8

Selector Switches

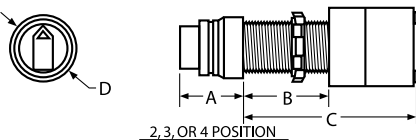

FIGURE 9

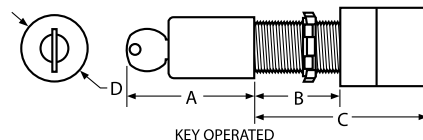

FIGURE 10

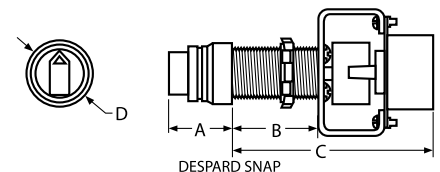

FIGURE 11

Push Buttons

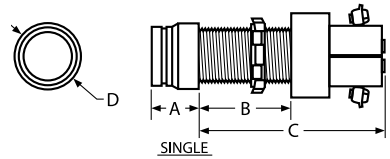

FIGURE 1

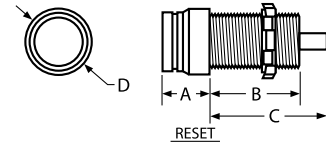

FIGURE 2

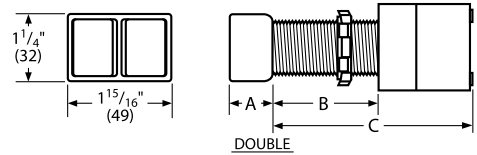

FIGURE 3

Pilot Lights

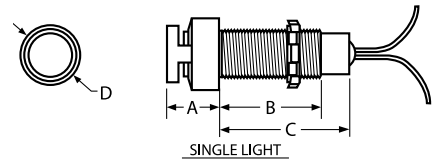

FIGURE 4

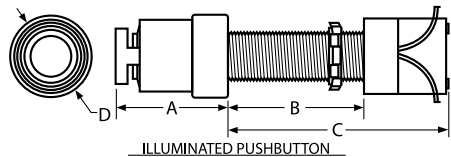

FIGURE 5

